

WOOJONG
宇中高虹



WOOJONG
PRODUCT CATALOG

Hangzhou Yuzhong Gaohong Lighting Electrical Equipment Co., Ltd.

Address: Gaohong South Street No.298 , Gaohong Town, Linan City, Hangzhou, Zhejiang Province, China 311307

Web: <http://www.woojong.com.cn>



Woojong is a comprehensive lighting group integrating research and development, manufacturing, marketing, projects design and construction. The company is the vice president unit of China Association of Lighting Industry and Association of Lighting Industry. It has won the honorary titles of famous export commodities and green manufacturing enterprise of Zhejiang Province, and has the class-A qualification of professional contracting of urban and road lighting engineering. The company covers an area of 70,000 square meters, with 220,000 square meters of standard modern workshop, more than 1,600 employees. Quality manufacturing concept has been throughout the company's development history. The company has passed ISO9001 international quality management system, ISO14001 environmental management system, ISO 45001 occupational health and safety management system certification. and meanwhile has obtained many domestic and international product certifications, such as CCC, CQC, UL, EnergyStar, FCC, GS, CE, ERP, KC, etc. Woojong is committed to becoming an industry leading, domestic first-class, internationally renowned lighting group.

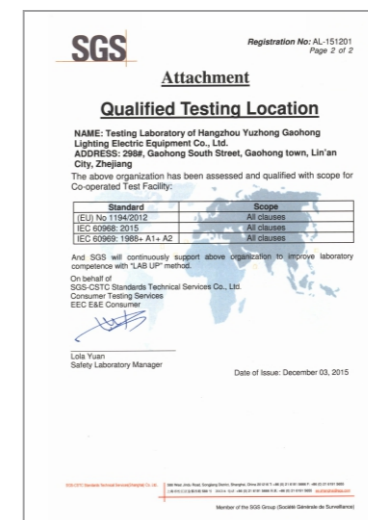
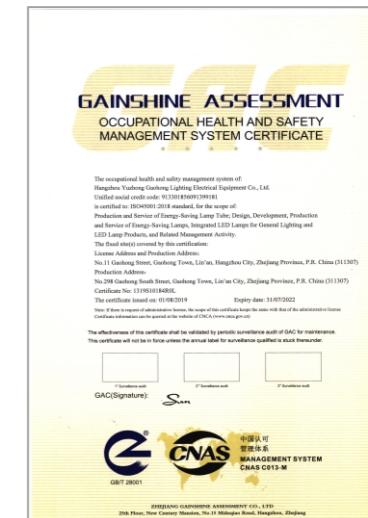
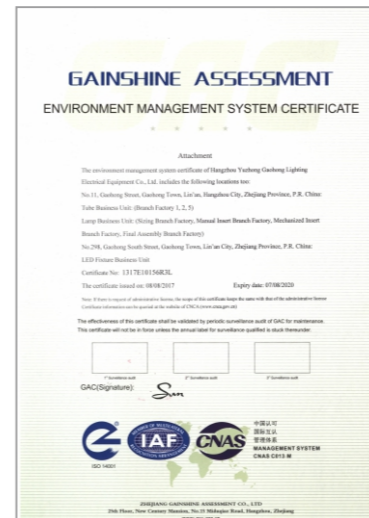
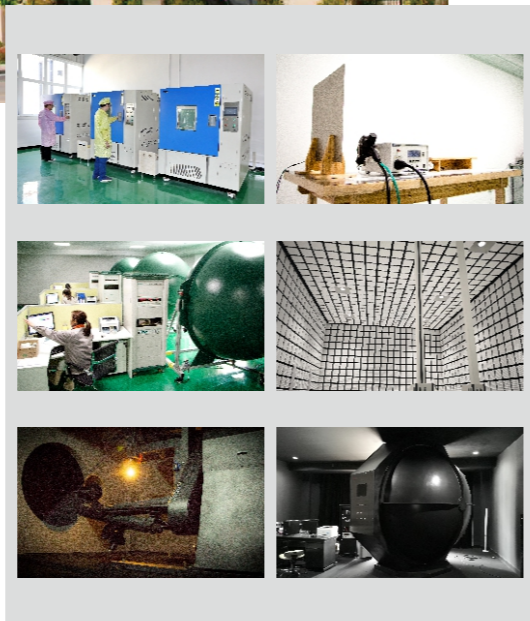

ABOUT OUR COMPANY

PRODUCT CATALOG

WOJONGLIGHTING

01-04 LED INTELLIGENT LAMP SERIES

05-22 LED GENERAL LAMP SERIES

23-48 LED INDOOR LUMINAIRES SERIES

49-60 LED OUTDOOR LUMINAIRES SERIES

61-66 EDUCATIONAL LIGHTING SERIES

67-68 UV LIGHT SERIES



LED INTELLIGENT LAMP SERIES



WIFI RGB INTELLIGENT DIMMABLE BULBS



- VOLTAGE(V) 100/120/220-240
- CCT(K) RGB+CW
- BASE E27/B22
- PF 0.5/0.9
- MATERIAL PLASTIC
- CRI ≥80
- IP 20
- DIMENSION(MM) Φ60x118
- LIFETIME(H) ≥15000

WATTAGE(W)	7 (LINEAR/ON-OFF)	9 (LINEAR/ON-OFF)
LUMINOUS(LM)	600	800
COLOR	RGB+CW	RGB+CW
CONTROL MODE	App/Alexa/GoogleAssistant	App/Alexa/GoogleAssistant
SUITABLE PHONE OS	Android 4.3/IOS7.0	Android 4.3/IOS7.0
CERTIFICATE	NEW CE/ERP	NEW CE/ERP
DRIVER	IC	IC

top **3** cloud supplier worldwide
230+ countries covered





SMART CANDLE LAMP

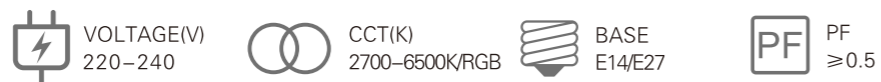

WATTAGE(W)	4.9
OPERATING TEMP	0.5
DRIVER	IC
EMC	YES
BEAM ANGLE	160°
DRIVER	IC



SMART RGB GU10



WATTAGE(W)	4.9
OPERATING TEMP	0.5
DRIVER	IC
EMC	YES
BEAM ANGLE	100°
DRIVER	IC

SMART LED UNIFORM
BRIGHTNESS AND COMFORT



LED GENERAL LAMP SERIES



LIGHT CONTROL BULBS-A60

- VOLTAGE(V)
220-240(110-264)
- CCT(K)
2700-7000
- BASE
E27/E26/B22
- PF
≥0.5
- MATERIAL
PLASTIC
- CRI
≥80
- IP
20
- LIFETIME(H)
≥15000

WATTAGE(W)	7	9
LUMINOUS(LM)	560	720
DIMENSION(MM)	Φ60x107	Φ60x107
INDUCTION MODE	LIGHT CONTROL	LIGHT CONTROL
INDUCED LUMINANCE	15LX/30LX	15LX/30LX
DRIVER	IC/LINEAR	IC/LINEAR



RADAR SENSOR+ LIGHT CONTROL BULBS-A60

- VOLTAGE(V)
220-240(110-264)
- CCT(K)
2700-7000
- BASE
E27/E26/B22
- PF
≥0.5
- MATERIAL
PLASTIC
- CRI
≥80
- IP
20
- LIFETIME(H)
≥15000

WATTAGE(W)	7	9
LUMINOUS(LM)	560	720
DIMENSION(MM)	Φ60x107	Φ60x107
DRIVER	IC/LINEAR	IC/LINEAR



BULB SERIES-A37

VOLTAGE(V) 90-110
 CCT(K) 3000/5000/6500
 BASE E17
 PF ≥ 0.5

MATERIAL PLASTIC
 CRI ≥ 80
 IP 20
 LIFETIME(H) ≥ 40000

WATTAGE(W)	2.1	4.1	6.1
LUMINOUS(LM)	280/300	530/560	780/810
DIMENSION(MM)	$\Phi 38 \times 78$	$\Phi 38 \times 78$	$\Phi 38 \times 78$
DRIVER	IC	IC	IC



BULB SERIES-A60

VOLTAGE(V) 100-265
 CCT(K) 3000/4000/6500
 BASE E27
 PF ≥ 0.5

MATERIAL PLASTIC
 CRI ≥ 80
 IP 20
 LIFETIME(H) ≥ 40000

WATTAGE(W)	10	13	16
EFFICACY(LM/W)	110/115	110/115	110/115
DIMENSION(MM)	$\Phi 60 \times 110$	$\Phi 60 \times 120$	$\Phi 70 \times 140$
DRIVER	IC	IC	IC



BULB SERIES-A60

VOLTAGE(V) 90-110
 CCT(K) 3000/5000/6500
 BASE E26
 PF ≥ 0.5
 IP 20

MATERIAL PLASTIC
 CRI ≥ 80
 BEAM ANGLE 260°
 LIFETIME(H) ≥ 40000

WATTAGE(W)	2.8	4.8	7.8
LUMINOUS(LM)	340/350	560/590	840/860
DIMENSION(MM)	$\Phi 60 \times 110$	$\Phi 60 \times 110$	$\Phi 60 \times 110$
DRIVER	IC	IC	IC



BULB SERIES-A65

VOLTAGE(V) 90-110
 CCT(K) 3000/5000/6500
 BASE E26
 PF ≥ 0.5

MATERIAL PLASTIC
 CRI ≥ 80
 IP 20
 LIFETIME(H) ≥ 40000

WATTAGE(W)	12.5
LUMINOUS(LM)	1530/1560
DIMENSION(MM)	$\Phi 65 \times 125$
DRIVER	IC



POWER ADJUSTABLE BULB-A65

VOLTAGE(V) 230V(100-240VAC)
 CCT(K) 2700-7000
 BASE E27/E26/B22
 MATERIAL PLASTIC

PF ≥ 0.5
 CRI ≥ 80
 IP 20
 LIFETIME(H) ≥ 15000

WATTAGE(W)	14
LUMINOUS(LM)	1100
DIMENSION(MM)	$\Phi 60 \times 120$
DRIVER	IC/LINEAR



CANDLE C37

VOLTAGE(V) 110-264/170-264
 CCT(K) 2700-7000
 BASE E14

PF ≥ 0.5
 CRI ≥ 80
 BEAM ANGLE 260° / 220°

MATERIAL PLASTIC
 LIFETIME(H) ≥ 15000

WATTAGE(W)	5
LUMINOUS(LM)	400
DIMENSION(MM)	$\Phi 37 \times 105 / \Phi 37 \times 100 / \Phi 37 \times 124$
DRIVER	IC/LINEAR



BULB SERIES

VOLTAGE(V) 110-264/170-264
 CCT(K) 2700-7000
 BASE E27 / E26 / B22
 PF ≥ 0.5

MATERIAL PLASTIC
 CRI ≥ 80
 BEAM ANGLE 220°
 LIFETIME(H) ≥ 15000

MODEL	A50	A55	A60	A65	A70	A80	A95
WATTAGE(W)	3/5	5/7	7/9/10/12	12	15	18	20/24
LUMINOUS(LM)	270/450	450/630	630/810 900/1080	1080	1350	1620	1800/2160
DIMENSION(MM)	$\Phi 50 \times 89$	$\Phi 55 \times 103$	$\Phi 60 \times 110$	$\Phi 65 \times 127$	$\Phi 70 \times 134$	$\Phi 80 \times 154$	$\Phi 95 \times 167$
DRIVER	DOB/IC/LINEAR						



CANDLE C35

VOLTAGE(V) 110-264/170-264
 CCT(K) 2700-7000
 BASE E14
 PF ≥ 0.5

CRI ≥ 80
 BEAM ANGLE 260°
 MATERIAL PLASTIC
 LIFETIME(H) ≥ 15000

WATTAGE(W)	5
LUMINOUS(LM)	350
DIMENSION(MM)	$\Phi 35 \times 103 / \Phi 37 \times 123$
DRIVER	IC



LED G45 ☆☆☆

VOLTAGE(V) 110-264/170-264
 CCT(K) 2700-7000
 BASE E27
 PF ≥0.5
 CRI ≥80
 BEAM ANGLE 200°
 MATERIAL PLASTIC
 LIFETIME(H) ≥15000

WATTAGE(W)	5
LUMINOUS(LM)	400
DIMENSION(MM)	Φ45x82
DRIVER	DOB/IC/LINEAR



LED MR16

VOLTAGE(V) DC12V
 CCT(K) 3000/6500
 CRI ≥80
 BASE GU5.3
 BEAM ANGLE 38°
 MATERIAL PLASTIC+AL
 LIFETIME(H) ≥15000

WATTAGE(W)	7.5	8
LUMINOUS(LM)	540/600	576/640
DIMENSION(MM)	Φ49.5x53	Φ49.5x53
DRIVER	IC	IC



LED GU10

VOLTAGE(V) 110-264/170-264
 CCT(K) 2700-7000
 BASE GU 10
 PF ≥0.5
 CRI ≥80
 BEAM ANGLE 40°
 MATERIAL PLASTIC
 LIFETIME(H) ≥15000

WATTAGE(W)	5
LUMINOUS(LM)	325
DIMENSION(MM)	Φ50x55
DRIVER	IC



LED MR16 ☆☆☆

VOLTAGE(V) 110-264/220-240
 CCT(K) 2700-7000
 CRI ≥80
 BASE GU10/GU5.3
 BEAM ANGLE 36° /100°
 MATERIAL PLASTIC
 LIFETIME(H) ≥15000

WATTAGE(W)	4.9	7
LUMINOUS(LM)	400	560/595
DIMENSION(MM)	Φ50x54	Φ50x54
DRIVER	IC/LINEAR	IC/LINEAR



LED T LAMP-A

Plastic Aluminum

VOLTAGE(V) 110-264
 CCT(K) 2700-7000
 BASE E27 / E26
 PF ≥ 0.5
 MATERIAL PLASTIC
 CRI ≥ 80
 BEAM ANGLE 220°
 LIFETIME(H) ≥ 15000

MODEL	T80	T100	T120	T140
WATTAGE(W)	20	30	40	50
LUMINOUS(LM)	1800	2700	3600	4500
DIMENSION(MM)	Φ80x149	Φ100x180	Φ118x209	Φ138x245
DRIVER	DOB/IC/LINEAR	DOB/IC/LINEAR	DOB/IC/LINEAR	DOB/IC/LINEAR



LED T LAMP-C

Plastic Aluminum

VOLTAGE(V) 110-264
 CCT(K) 2700-7000
 BASE E27/E26/B22
 PF ≥ 0.5
 MATERIAL PLASTIC
 CRI ≥ 80
 IP 20
 LIFETIME(H) ≥ 15000
 BEAM ANGLE 220°

MODEL	T80	T100	T120	T140	T160
WATTAGE (W)	20	30	40	50	55
LUMINOUS (LM)	1700	2550	3200	3950	4675
DIMENSION (MM)	Φ80x143	Φ100x166	Φ120x202	Φ140x227	Φ160x276
DRIVER	DOB/IC/LINEAR	DOB/IC/LINEAR	DOB/IC/LINEAR	DOB/IC/LINEAR	DOB/IC/LINEAR



LED T LAMP-B ☆☆☆

Plastic Aluminum

VOLTAGE(V) 110-264
 CCT(K) 2700-7000
 CRI ≥ 80
 BASE E27/E26/B22
 MATERIAL PLASTIC
 IP 20
 LIFETIME(H) ≥ 15000
 BEAM ANGLE 220°

MODEL	T80	T100	T120	T140
WATTAGE (W)	20	30	40	50
LUMINOUS (LM)	1700	2550	3400	4250
DIMENSION(MM)	Φ80x130	Φ100x150	Φ118x175	Φ138x200
DRIVER	DOB/IC/LINEAR	DOB/IC/LINEAR	DOB/IC/LINEAR	DOB/IC/LINEAR



LED T LAMP-D

Plastic Aluminum

VOLTAGE(V) 110-264
 CCT(K) 2700-7000
 BEAM ANGLE 220°
 PF ≥ 0.5
 CRI ≥ 80
 LIFETIME(H) ≥ 15000
 IP 20
 BASE E27/E26/B22
 MATERIAL PLASTIC

MODEL	T80	T100	T120	T140
WATTAGE (W)	20	30	40	50
LUMINOUS (LM)	1700	2550	3200	3950
DIMENSION (MM)	Φ80x143	Φ100x166	Φ120x202	Φ140x227
DRIVER	DOB/IC/LINEAR	DOB/IC/LINEAR	DOB/IC/LINEAR	DOB/IC/LINEAR



LED T LAMP-E

Die-Casting Aluminum

- VOLTAGE(V) 170-264
- CCT(K) 3000-6500
- BASE E27 / E26
- PF ≥ 0.5
- MATERIAL AL+PLASTIC
- CRI ≥ 80
- BEAM ANGLE 120°
- LIFETIME(H) ≥ 15000

MODEL	T80	T100	T120	T140
WATTAGE(W)	18-20	27-30	36-40	45-50
EFFICACY(LM/W)	90lm/w	90lm/w	90lm/w	90lm/w
DIMENSION(MM)	Φ80x112	Φ100x134	Φ118x154	Φ138x173
DRIVER	IC	IC	IC	IC



LED UFO LAMP-A



- VOLTAGE(V) 170-264
- CCT(K) 3000-7000
- BASE E27/E26
- PF ≥ 0.5
- MATERIAL PLASTIC
- CRI ≥ 80
- BEAM ANGLE 120°
- LIFETIME(H) ≥ 15000

WATTAGE(W)	12	15	20	28	38	48
LUMINOUS(LM)	950/1080	1200/1350	1600/1800	2250/2500	3050/3400	3850/4300
DIMENSION(MM)	Φ120x90	Φ150x95	Φ200x95	Φ223x100	Φ260x100	Φ310x108
DRIVER	IC	IC	IC	IC	IC	IC



LED T LAMP-F



Die-Casting Aluminum

- VOLTAGE(V) 110-264
- CCT(K) 2700-7000
- BASE E27 / E26
- PF ≥ 0.5
- MATERIAL AL+PLASTIC
- CRI ≥ 80
- BEAM ANGLE 220°
- LIFETIME(H) ≥ 15000

MODEL	T80	T100	T120	T140	T150
WATTAGE(W)	20	30	40/50	60/70	80
LUMINOUS(LM)	1800	2700	3600/4500	5400/6300	7200
DIMENSION(MM)	Φ80x149	Φ100x180	Φ118x209	Φ140x229	Φ150x259
DRIVER	IC	IC	IC	IC	IC



LED UFO LAMP-B

- VOLTAGE(V) 170-264
- CCT(K) 3000-6500
- BASE E27/E26
- PF ≥ 0.5
- MATERIAL AL+PLASTIC
- CRI ≥ 80
- BEAM ANGLE 120°
- LIFETIME(H) ≥ 15000

WATTAGE(W)	30	50
LUMINOUS(LM)	2700	4500
DIMENSION(MM)	Φ130x143	Φ150x162
DRIVER	IC	IC



LED PAR30 LAMP

VOLTAGE(V) 110-264/220-240
 CCT(K) 3000-6500
 BASE E27/E26
 PF 0.5/0.9

MATERIAL PLASTIC
 CRI ≥80
 BEAM ANGLE 36° /100°
 LIFETIME(H) ≥15000

WATTAGE(W)	15
LUMINOUS(LM)	1200
DIMENSION(MM)	Φ93x88
DRIVER	IC/LINEAR



LED PAR38 LAMP

VOLTAGE(V) 110-264
 CCT(K) 3000-6500
 BASE E27/E26
 PF 0.5/0.9

MATERIAL PLASTIC
 CRI ≥80
 BEAM ANGLE 38°
 LIFETIME(H) ≥15000

WATTAGE(W)	15
LUMINOUS(LM)	1200
DIMENSION(MM)	Φ120x136
DRIVER	IC



LED SLIM T LAMP ☆☆☆

VOLTAGE(V) 170-264
 CCT(K) 2700-7000
 BASE E27
 PF ≥0.5

MATERIAL PLASTIC
 CRI ≥80
 BEAM ANGLE 220°
 LIFETIME(H) ≥15000

MODEL	T29	T37	T45	T50
WATTAGE(W)	5	9	12	14
LUMINOUS(LM)	450/425	810/765	1080/1020	1260/1190
DIMENSION(MM)	Φ30x100	Φ37x122	Φ45x138	Φ50x145
DRIVER	IC	IC	IC	IC



LED R LAMP

VOLTAGE(V) 170-264
 CCT(K) 2700-7000
 BASE E14/E27
 PF ≥0.5

MATERIAL PLASTIC
 CRI ≥80
 BEAM ANGLE 120°
 LIFETIME(H) ≥15000

MODEL	R39	R50	R63	R80
WATTAGE(W)	4	6	9	13
LUMINOUS(LM)	340/320	510/480	765/720	1040/1105
DIMENSION(MM)	Φ39x69	Φ50x86	Φ63x100	Φ80x115
DRIVER	IC	IC	IC	IC



LED U LAMP

VOLTAGE(V) 170-265
 CCT(K) 3000/6500
 CRI ≥80
 MATERIAL PLASTIC
 OPERATING TEMP -20°C~30°C
 PF >0.9
 IP 20
 LIFETIME(H) ≥25000

MODEL	35W(4U)	35W(4U)	45W(4U)	45W(4U)	50W(4U)
WATTAGE (W)	35	35	45	45	50
LUMINOUS (LM)	3150/3500	3150/3500	4050/4500	4050/4500	4500/5000
EFFICACY (LM/W)	90/100	90/100	90/100	90/100	90/100
BASE	E26/E27	E39/E40	E39/E40	E26/E27	E39
DIMENSION(MM)	Φ74x238	Φ74x250	Φ74x280	Φ74x268	Φ88x290



LED TR LAMP

VOLTAGE(V) 220-240
 CCT(K) 2700-7000
 BASE E27
 MATERIAL PLASTIC
 PF ≥0.5
 CRI ≥80
 BEAM ANGLE 110°
 LIFETIME(H) ≥15000

WATTAGE(W)	5	9	12	15	18
LUMINOUS(LM)	450	900	1200	1500	1800
DIMENSION(MM)	Φ65x92	Φ90x120	Φ110x117	Φ128x159	Φ128x159
DRIVER	IC	IC	IC	IC	IC



LED TR ILLUMINANT

VOLTAGE(V) 220-240
 CCT(K) 2700-7000
 BASE E27
 MATERIAL PLASTIC
 PF ≥0.5
 CRI ≥80
 BEAM ANGLE 110°
 LIFETIME(H) ≥15000

WATTAGE(W)	5	9	12	15	18	30
LUMINOUS(LM)	450	900	1200	1500	1710	2800
EFFICIENCY(LM/W)	90	100	100	100	95	95
DIMENSION(MM)	Φ65x88	Φ90x115	Φ110x117	Φ128x129	Φ128x129	Φ158x168











EMERGENCY BULBS-A

VOLTAGE(V) 230V(110-240VAC)
 CCT(K) 2700-7000
 BASE E27/E26/B22
 MATERIAL PLASTIC
 PF ≥0.5
 CRI ≥80
 IP 20
 LIFETIME(H) ≥15000

WATTAGE(W)	7	9	12	18
LUMINOUS(LM)	600	800	950	1600
DIMENSION(MM)	Φ60x123	Φ68x143	Φ78x153	Φ95x188
DRIVER	IC	IC	IC	IC







EMERGENCY BULBS-B

-  VOLTAGE(V)
110-264
-  CCT(K)
2700-7000
-  CRI
≥80
-  MATERIAL
PLASTIC
-  PF
≥0.5
-  LIFETIME(H)
≥15000
-  IP
20
-  BASE
E27/E26/B22
-  Battery(mAh)
1200/1500

WATTAGE (W)	12	15
LUMINOUS (LM)	918	1080
DIMENSION (MM)	Φ80x167	Φ95x192
DRIVER	IC	IC



PLANT GROWTH LAMP

-  VOLTAGE(V)
108-132
-  CCT(K)
3000+LDR
-  CRI
≥80
-  MATERIAL
PLASTIC
-  PF
≥0.5
-  LIFETIME(H)
≥15000
-  BASE
E26
-  OPERATING TEMP
-20~40℃

WATTAGE (W)	8.5	
PPF	6UMOL/S, 14UMOL/S	
DIMENSION (MM)	Φ95.5x132	
SPECTRAL INTENSITY RATIO	Seeding	1:0.6
	Vegetative	1:0.6
	Fruiting	1:0.4



LED INDOOR LUMINAIRES SERIES

LED BATTEN LIGHT-A

- VOLTAGE(V) 170-264
- CCT(K) 3000-6500
- OPERATING TEMP -10~40°C
- CRI ≥80
- LIFETIME(H) ≥15000
- IP 20

WATTAGE (W)	20	30	40
PF	> 0.9	> 0.9	> 0.9
EFFICIENCY(LM/W)	80/90	80/90	80/90
DIMENSION (MM)	600x74x28	900x74x28	1200x74x28

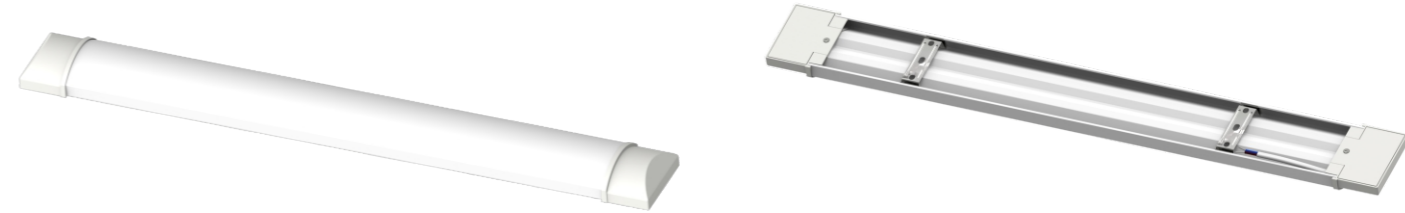

LED BATTEN LIGHT-B





- VOLTAGE(V) 170-264
- CCT(K) 3000-6500
- PF ≥0.5
- CRI ≥80
- LIFETIME(H) ≥15000
- IP 20
- OPERATING TEMP -10~40°C

WATTAGE (W)	40
EFFICIENCY(LM/W)	90/100
DIMENSION (MM)	1200x75x33





LED BATTEN LIGHT-C

 VOLTAGE(V) 220-240	 CCT(K) 3000-7000	 PF ≥0.5
 CRI ≥80	 LIFETIME(H) ≥15000	 IP 20
 OPERATING TEMP -10~40°C		

WATTAGE (W)	30	60
EFFICIENCY(LM/W)	80/90	80/90
DIMENSION (MM)	600x113x50	1200x113x50

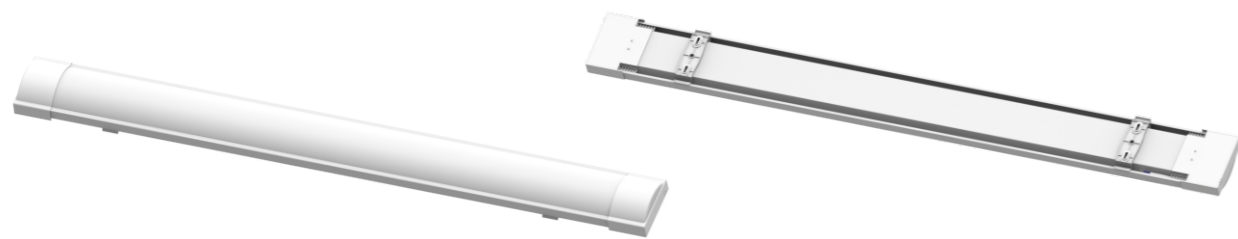

LINEAR LAMP

 VOLTAGE(V) 170-265/220-240	 CCT(K) 3000-6500	 PF ≥0.5	 MATERIAL PLASTIC
 CRI ≥80	 BEAM ANGLE 120°	 LIFETIME(H) ≥15000	

WATTAGE(W)	27	45
LUMINOUS(LM)	2000/2400 1800/2150	3370/3800 3150/3600
EFFICACY(LMW)	75/85 70/80	75/85 70/80
DIMENSION(MM)	600x60x52	900x60x52



Installation method

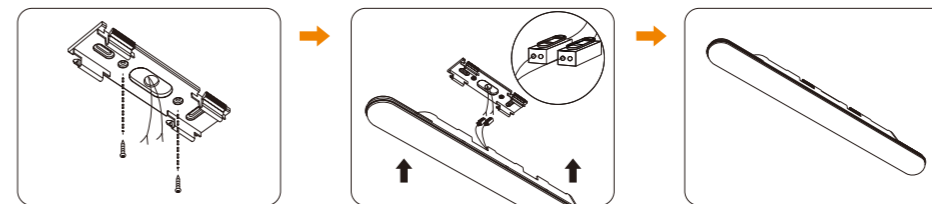

Disassembling method

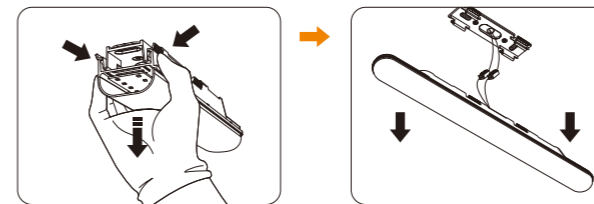

Installation requirements and maintenance

- First check the lamp parts and accessories.
- Power must be switched off before installation.
- Connect the wires from the lamp body to a dedicated drive.
- At the input of the drive, connect the matching power cord.
- Make sure the product is fastened to the surface of the object to be installed and the following operation is performed.

CROSS-LAMP



WATTAGE(W) 50W
 VOLTAGE(V) 220-240
 CCT(K) 3000/6500
 LUMINOUS(LM) 4000
 MATERIAL PLASTIC
 PF ≥ 0.5
 CRI ≥ 80
 BEAM ANGLE 120°
 DIMENSION(MM) 600x600x50.5
 LIFETIME(H) ≥ 15000

Installation method

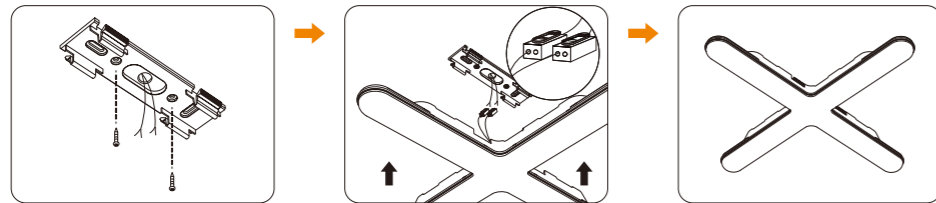

Disassembling method

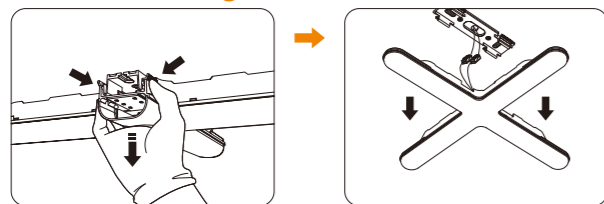

Installation requirements and maintenance

- First check the lamp parts and accessories.
- Power must be switched off before installation.
- Connect the wires from the lamp body to a dedicated drive.
- At the input of the drive, connect the matching power cord.
- Make sure the product is fastened to the surface of the object to be installed and the following operation is performed.

LED PLL LIGHT

VOLTAGE(V) 170-264
 CCT(K) 2700-7000
 PF ≥ 0.5
 MATERIAL GLASS
 CRI ≥ 80
 BEAM ANGLE 330°
 LIFETIME(H) ≥ 15000

WATTAGE(W)	16	18	20	22	24
LUMINOUS(LM)	1360	1530	1800	1980	2160
DIMENSION(MM)	44x23x420	44x23x420	44x23x420	44x23x545	44x23x545









LED T5 LIGHT

VOLTAGE(V) 170-265
 CCT(K) 3000-6500
 PF ≥ 0.5
 MATERIAL PLASTIC
 CRI ≥ 80
 BEAM ANGLE 220°
 LIFETIME(H) 25000

WATTAGE(W)	5	10	15	20
LUMINOUS(LM)	400/450	800/900	1200/1350	1600/1800
DIMENSION(MM)	312x22x35	575x22x35	873x22x35	1174x22x35









LED T8 LIGHT

 VOLTAGE(V) 110-264
 CCT(K) 3000/6500
 PF >0.9
 MATERIAL PLASTIC
 CRI ≥80
 BEAM ANGLE 150°
 LIFETIME(H) ≥15000

WATTAGE(W)	6	9	18	20
LUMINOUS(LM)	600	900	1800	2000
DIMENSION(MM)	Φ28x436	Φ28x590	Φ28x1200	Φ28x1200





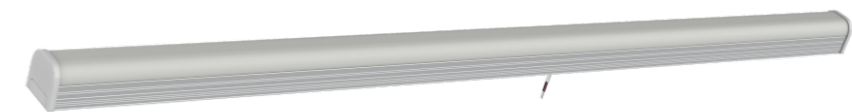

PARKING LIGHT-B

 VOLTAGE(V) 170-265
 CCT(K) 3000-6500
 PF ≥0.9
 MATERIAL Aluminum +Plastic
 CRI ≥80
 BEAM ANGLE 120°
 LIFETIME(H) 25000

WATTAGE(W)	28	49	20	40	60
LUMINOUS(LM)	3000/4000	3000/7000	1800/2000	3000/4000	3000/6000
EFFICIENCY(LM/W)	130/143	130/143	90/100	90/100	90/100
DIMENSION(MM)	1200x51x48	1200x51x48	600x51x48	1200x51x48	1200x51x48











PARKING LIGHT-A

 VOLTAGE(V) 220-240
 CCT(K) 3000-6500
 PF >0.9
 MATERIAL Aluminum +Plastic
 CRI ≥80
 BEAM ANGLE 120°
 LIFETIME(H) ≥25000

WATTAGE(W)	40	60
LUMINOUS(LM)	3200/3600	4800/5400
DIMENSION(MM)	1200x58x48	1200x58x48



TRI-PROOF LIGHT-A

 VOLTAGE(V) 170-265
 CCT(K) 3000/6500
 PF >0.9
 MATERIAL PLASTIC
 CRI ≥80
 IP 65
 LIFETIME(H) ≥15000
 OPERATING TEMP -20~40°C

WATTAGE(W)	20	30	40	50
LUMINOUS(LM)	1600/1800	2400/2700	2880/3240	4400/4950
DIMENSION(MM)	600x75x63	900x75x63	1200x75x63	1500x75x63



TRI-PROOF LIGHT-B

Suitable for cold storage

VOLTAGE(V) 170-265
 CCT(K) 3000/6500
 PF >0.9
 MATERIAL PLASTIC
 CRI ≥80
 IP 65
 LIFETIME(H) ≥15000
 OPERATING TEMP -40~40°C

WATTAGE(W)	18	36	54	60
LUMINOUS(LM)	1440/1620	2880/3240	4320/4860	4800/5400
DIMENSION(MM)	600x75x63	1200x75x63	1200x75x63	1500x75x63

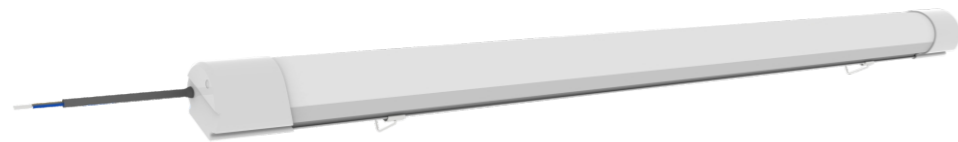

LED MOISTURE PROOF LAMP-A



VOLTAGE(V) 220-240
 CCT(K) 6500
 PF ≥0.5
 MATERIAL PLASTIC
 CRI ≥80
 BEAM ANGLE 110°
 LIFETIME(H) ≥25000

WATTAGE(W)	15	20	24	30
LUMINOUS(LM)	1200	1600	1920	2400
DIMENSION(MM)	Φ178x55	Φ225x50	Φ265x50	Φ310x50

LED NEW MOISTURE PROOF LAMP

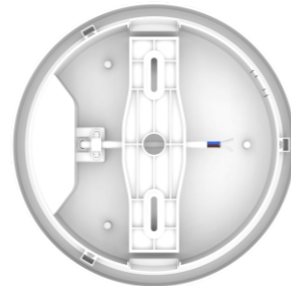

VOLTAGE(V) 110-265
 CCT(K) 3000-6500
 PF ≥0.5
 MATERIAL PLASTIC
 CRI ≥80
 IP 20
 LIFETIME(H) ≥15000

WATTAGE(W)	15	20	24	30
LUMINOUS(LM)	1080/1200	1440/1600	1728/1920	2160/2400
DIMENSION(MM)	165x64	210x64	210x64	265x64

LED CEILING LAMP-A

VOLTAGE(V) 220-240
 WATTAGE(W) 15W
 CCT(K) 6500/7000
 LUMINOUS(LM) 1100
 PF ≥0.5
 CRI ≥80
 MATERIAL PLASTIC
 BEAM ANGLE 110°
 DIMENSION(MM) Φ237x63
 LIFETIME(H) ≥15000

WATTAGE(W)	15
LUMINOUS(LM)	1125
DIMENSION(MM)	Φ237x63









LED CEILING LAMP-B

 VOLTAGE(V) 220-240
 CCT(K) 3000-6500
 PF ≥ 0.5
 CRI ≥ 80
 MATERIAL PLASTIC
 LIFETIME(H) ≥ 15000

WATTAGE(W)	15
LUMINOUS(LM)	1100/1250
DIMENSION(MM)	$\Phi 222 \times 43$









LED CEILING LAMP-D

 VOLTAGE(V) 110-264
 CCT(K) 3000-6500
 PF ≥ 0.5
 MATERIAL PLASTIC
 CRI ≥ 80
 BEAM ANGLE 110°
 LIFETIME(H) ≥ 25000

WATTAGE(W)	12	18	24
LUMINOUS(LM)	840/960	1260/1440	1680/1920
DIMENSION(MM)	$\Phi 260 \times 65$	$\Phi 330 \times 65$	$\Phi 380 \times 65$









LED CEILING LAMP-C

 VOLTAGE(V) 110-264
 CCT(K) 3000-6500
 PF ≥ 0.5
 MATERIAL PLASTIC
 CRI ≥ 80
 BEAM ANGLE 110°
 LIFETIME(H) ≥ 25000

WATTAGE(W)	12	18	24	36
LUMINOUS(LM)	840/960	1260/1440	1680/1920	2520/2880
DIMENSION(MM)	$\Phi 260 \times 80$	$\Phi 330 \times 95$	$\Phi 380 \times 110$	$\Phi 380 \times 110$



LED CEILING LAMP-E

 VOLTAGE(V) 110-264
 CCT(K) 2700-7000
 PF ≥ 0.5
 MATERIAL PLASTIC
 CRI ≥ 80
 BEAM ANGLE 110°
 LIFETIME(H) ≥ 25000

WATTAGE(W)	30	36	50	60
LUMINOUS(LM)	2550	3060	4250	4800
DIMENSION(MM)	$\Phi 380 \times 100$	$\Phi 400 \times 75$	$\Phi 480 \times 120$	$\Phi 500 \times 75$



LED CEILING LAMP-F

VOLTAGE(V) 110-264 CCT(K) 3000/4000/6500 PF ≥ 0.5

MATERIAL PLASTIC CRI ≥ 80 IP 20 LIFETIME(H) 25000



WATTAGE(W)	18	24	36
LUMINOUS(LM)	1440	1920	2880
DIMENSION(MM)	Φ330x70	Φ380x75	Φ380x75

LED CEILING LAMP-H

VOLTAGE(V) 110-264 CCT(K) 3000/4000/6500 PF ≥ 0.5

MATERIAL PLASTIC CRI ≥ 80 IP 20 LIFETIME(H) 25000



WATTAGE(W)	36	60
LUMINOUS(LM)	2880	4800
DIMENSION(MM)	Φ500x80	Φ500x80

LED CEILING LAMP-G

VOLTAGE(V) 110-264 CCT(K) 3000/4000/6500 PF ≥ 0.5

MATERIAL PLASTIC CRI ≥ 80 IP 20 LIFETIME(H) 25000



WATTAGE(W)	12	18	24	36
LUMINOUS(LM)	960	1440	1920	2880
DIMENSION(MM)	Φ260x65	Φ330x65	Φ380x65	Φ380x65

LED CEILING LAMP-I

VOLTAGE(V) 90-110 CCT(K) 3000/6500 PF > 0.5 MATERIAL PLASTIC

CRI ≥ 80 IP 40 LIFETIME(H) ≥ 40000

WATTAGE(W)	7.6	8	13.9	14.4	24
LUMINOUS(LM)	608/684	640/720	1112/1251	2400/2700	1920/2160
DIMENSION(MM)	Φ132x36	Φ132x38.5	Φ165x36	Φ165x38.5	Φ205x36/Φ205x38.5



CEILING LAMP WITH MICROWAVE INDUCTION

WATTAGE(W)	12	18	24
LUMINOUS(LM)	80	80	80
DIMENSION(MM)	Φ 260x85	Φ 330x95	Φ 380x110



- VOLTAGE(V) 110-264
- CCT(K) 3000-6500
- PF ≥0.5
- MATERIAL PLASTIC
- CRI ≥80
- BEAM ANGLE 110°
- LIFETIME(H) ≥15000

SURFACE-MOUNTED SLIM PANEL

VOLTAGE(V)	170-264	CCT(K)	3000-6500	PF	≥0.5	BEAM ANGLE	120°
MATERIAL	PLASTIC	CRI	≥80	LIFETIME(H)	≥15000		
WATTAGE(W)	16	21					
LUMINOUS(LM)	1150/1300	1470/1700					
EFFICIENCY(LM/W)	70/80	70/80					
DIMENSION(MM)	Φ 180x18	Φ 220x18					



CEILING LAMP WITH DIMMABLE, INFRARED INDUCTION

WATTAGE(W)	18	24	36
LUMINOUS(LM)	80	80	80
DIMENSION(MM)	Φ 290x70	Φ 388x70	Φ 485x65



- VOLTAGE(V) 110-264
- CCT(K) 3000-6500
- PF ≥0.5
- MATERIAL PLASTIC
- CRI ≥80
- BEAM ANGLE 110°
- LIFETIME(H) ≥25000





LED CEILING LAMP-J

WATTAGE(W)	50
LUMINOUS(LM)	4500/5000
DIMENSION(MM)	Φ 530x90

- VOLTAGE(V) 170-264
- CCT(K) 3000-6500
- PF ≥0.9
- MATERIAL PLASTIC
- CRI ≥80
- BEAM ANGLE 120°
- LIFETIME(H) ≥25000



LED CEILING LAMP-K



 VOLTAGE(V) 110-264
  CCT(K) 6500/7000
  PF ≥ 0.5
 MATERIAL AL+PLASTIC

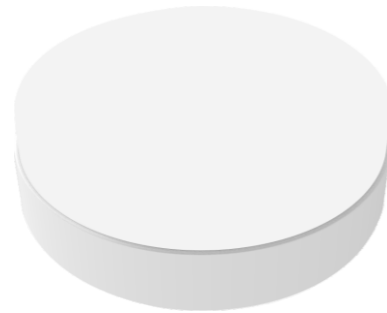

 CRI ≥ 80
 BEAM ANGLE 110°
  LIFETIME(H) ≥ 25000

WATTAGE(W)	15	18	24	36
LUMINOUS(LM)	1200	1440	1920	2880
DIMENSION(MM)	Φ120x55	Φ180x55	Φ220x55	Φ300x55



LED PANEL LIGHT-A

 VOLTAGE(V) 110-264
  CCT(K) 3000/6500
  PF ≥ 0.5
 MATERIAL PLASTIC

 CRI ≥ 80
 BEAM ANGLE 110°
  LIFETIME(H) ≥ 25000

WATTAGE(W)	18	24	36
EFFICIENCY(LM/W)	80/85	80/85	80/85
DIMENSION(MM)	Φ190x22	Φ225x22	Φ250x22
CUT OUT(MM)	158-162	183-188	213-218

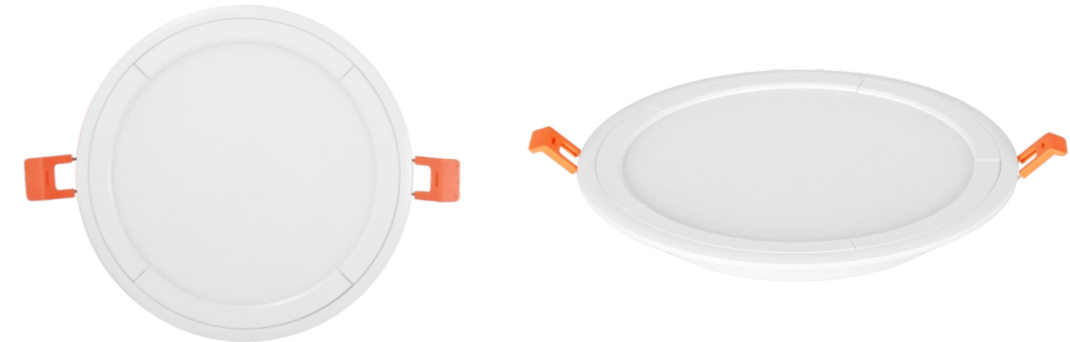

LED PANEL LIGHT





 VOLTAGE(V) 110-264
  CCT(K) 6500/7000
  PF ≥ 0.5
 MATERIAL AL+PLASTIC



 CRI ≥ 80
 BEAM ANGLE 110°
  LIFETIME(H) ≥ 15000

WATTAGE(W)	18	24	36
LUMINOUS(LM)	1440	1920	2880
DIMENSION(MM)	120x120x40	175x175x40	225x225x40



LED PANEL LIGHT-B

 VOLTAGE(V) 110-264
  CCT(K) 3000/6500
  PF ≥ 0.5
 MATERIAL PLASTIC

 CRI ≥ 80
 BEAM ANGLE 110°
  LIFETIME(H) ≥ 25000

WATTAGE(W)	12	15	18	18	36
EFFICIENCY(LM/W)	80/90	90/95	90/95	90/95	90/95
DIMENSION(MM)	150x150x22	175x175x22	190x190x22	215x215x22	300x300x22
CUT OUT(MM)	135-140	156-161	165-170	195-200	275-280

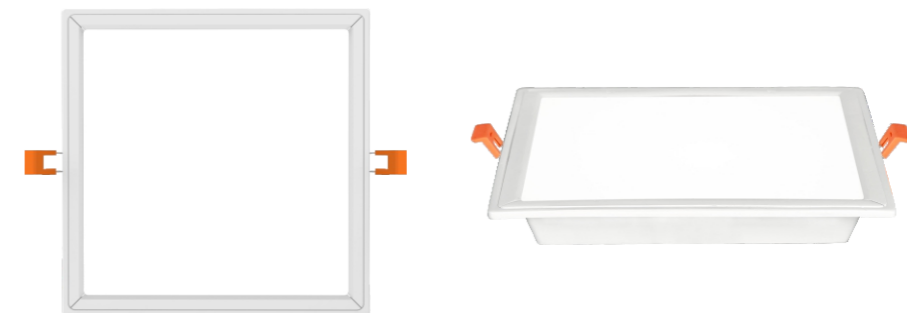

PANEL LIGHT WITH ADJUSTABLE OPENING DIMENSION

VOLTAGE(V) 110-264 CCT(K) 3000-6500 PF ≥ 0.5 MATERIAL PLASTIC

CRI ≥ 80 IP 20 LIFETIME(H) 25000

WATTAGE(W)	10	18	24	36
LUMINOUS(LM)	750/800	1350/1440	1800/1920	2700/2880
OPERATING FREQUENCY	50/60	50/60	50/60	50/60
DIMENSION(MM)	$\Phi 100 \times 37$	$\Phi 125 \times 37$	$\Phi 175 \times 37$	$\Phi 230 \times 37$
HOLE SIZE	55-85	55-110	55-160	55-220

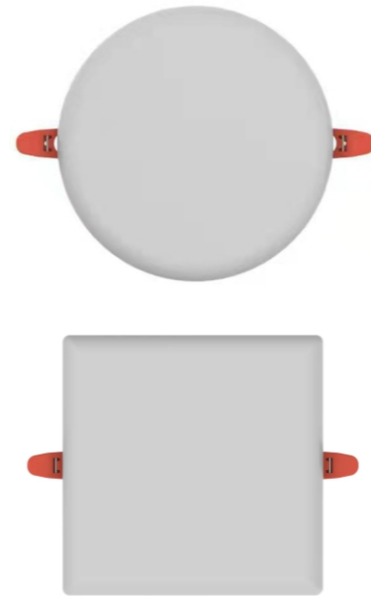

LED PANEL LIGHT-C

VOLTAGE(V) 170-264 CCT(K) 3000-6500 PF > 0.9 MATERIAL AL+PLASTIC

CRI ≥ 80 BEAM ANGLE 110° LIFETIME(H) ≥ 25000

WATTAGE(W)	42	48
LUMINOUS(LM)	85/95	85/95
DIMENSION(MM)	595x595x8	595x595x8
CUT OUT(MM)	535	535



LED PANEL LIGHT-D

VOLTAGE(V) 170-264 CCT(K) 3000-6500 PF ≥ 0.5 MATERIAL AL+PLASTIC

CRI ≥ 80 BEAM ANGLE 110° LIFETIME(H) ≥ 25000

WATTAGE(W)	20	36	48
LUMINOUS(LM)	1400/1600	2500/2850	3840/4320
DIMENSION(MM)	300x300x30	300x600x30	600x600x30

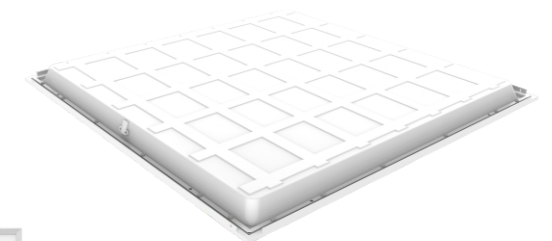

LED PANEL LIGHT-E

VOLTAGE(V) 170-264 CCT(K) 6500 PF 0.9 MATERIAL AL+PLASTIC

CRI ≥ 80 BEAM ANGLE 110° LIFETIME(H) ≥ 25000

WATTAGE(W)	18	25	25	40	40	50	40	50
DIMENSION(MM)	1440	2000	2000	3600	3600	4500	3600	4500
DIMENSION(MM)	320x320x25	640x180x25	640x320x25	450x450x25	520x520x25	640x640x25	1285x180x25	1285x320x25



LED DOWNLIGHT-UGR

 VOLTAGE(V) 110-264
  CCT(K) 3000-6500
  PF ≥ 0.5
 MATERIAL PLASTIC



 CRI ≥ 80
 BEAM ANGLE 100°
  LIFETIME(H) 15000/25000



WATTAGE(W)	3	6	9	12	15
LUMINOUS(LM)	195/210	390/420	630/675	840/900	1050/1125
DIMENSION(MM)	Φ88x56	Φ105x60	Φ125x60	Φ150x65	Φ150x65
CUT OUT(MM)	70	80	105	130	130

LED DOWNLIGHT-A

 VOLTAGE(V) 220-240
  CCT(K) 3000-6500
  MATERIAL PLASTIC

 PF ≥ 0.5
 CRI ≥ 80
 DIMENSION(MM) Φ100x30
  LIFETIME(H) ≥ 15000



WATTAGE(W)	5	8	12	20	25	30
LUMINOUS(LM)	300/350	520/560	840/900	1350/1500	1750/1950	2100/2300
DIMENSION(MM)	Φ100x30	Φ120x35	Φ150x35	Φ170x35	Φ198x35	Φ224x35

COB SPOTLIGHT

 VOLTAGE(V) 110-264
  CCT(K) 2700-6500
  PF ≥ 0.5
 MATERIAL PLASTIC

 CRI ≥ 80
 BEAM ANGLE 24°&38°
  LIFETIME(H) ≥ 25000



WATTAGE(W)	5	7
LUMINOUS(LM)	375/400	525/560
DIMENSION(MM)	Φ92x72	Φ92x72

LED DOWNLIGHT-B





 VOLTAGE(V) 110-264
  CCT(K) 3000/6500
  PF ≥ 0.5
 MATERIAL PLASTIC



 CRI ≥ 80
 BEAM ANGLE 100°
  LIFETIME(H) 15000/25000



WATTAGE(W)	3	6	9	12	15	18
EFFICIENCY(LM/W)	65/70	65/70	65/70	65/70	65/70	65/70
DIMENSION(MM)	Φ88x45	Φ105x49	Φ125x49	Φ150x54	Φ150x54	Φ175x58
CUT OUT(MM)	70	80	105	130	130	155

LED DOWNLIGHT-C



 VOLTAGE(V)
220-240/170-240
  CCT(K)
3000-6500
  PF ≥ 0.5
 MATERIAL
PLASTIC





 CRI ≥ 80
 IP 20
  LIFETIME(H)
25000



WATTAGE(W)	6	9	12	15	18	24	30
LUMINOUS(LM)	480	720	960	1200	1600	1920	2400
OPERATING FREQUENCY	50/60	50/60	50/60	50/60	50/60	50/60	50/60
DIMENSION(MM)	Φ101x32	Φ116x32.5	Φ132x32.5	Φ151x32/Φ176x32.5	Φ176x32.5	Φ201x32.5	Φ226x32.5
HOLZ SIZE	70	85	100	120	140	170	195
DRIVER	LINEAR /DOB	LINEAR /DOB	LINEAR /DOB	LINEAR /DOB	LINEAR /DOB	LINEAR /DOB	LINEAR /DOB

LED DOWNLIGHT-D

 VOLTAGE(V)
220-240/110-264/100-240
  CCT(K)
3000-6500
  PF ≥ 0.5



 MATERIAL
PLASTIC
  CRI ≥ 80
 IP 20
  LIFETIME(H)
25000







WATTAGE(W)	5	8	12	15	18	24
LUMINOUS(LM)	300/350	520/560	840/900	1050/1125	1260/1350	1680/1800
DIMENSION(MM)	Φ100x30	Φ115x30	Φ145x31	Φ175x31	Φ198x32	Φ224x36
HOLZ SIZE(MM)	70	85	110	130	150	175

INTELLIGENT DIMMABLE LED DOWNLIGHT



 VOLTAGE(V)
220-240
  CCT(K)
3000-6500
  PF ≥ 0.5

 MATERIAL
PLASTIC
  CRI ≥ 80
 BEAM ANGLE
110°
  LIFETIME(H)
 ≥ 15000



WATTAGE(W)	4.9	8	10	12	15
LUMINOUS(LM)	200	340	585	840	1050
EFFICIENCY(LM/W)	501	501	651	701	701
DIMENSION(MM)	Φ88x45	Φ105x49	Φ125x49	Φ150x54	Φ175x67

LED SPOT LIGHT







 VOLTAGE(V)
110-264
  CCT(K)
3000-6500
  PF ≥ 0.9
 MATERIAL
PLASTIC

 CRI ≥ 80
 BEAM ANGLE
45°/55°
  LIFETIME(H)
 ≥ 25000

WATTAGE(W)	5	7	9	12
LUMINOUS(LM)	375/400	525/560	675/720	900/960
DIMENSION(MM)	95x95x48	95x95x48	117x117x52	140x140x55
CUT OUT(MM)	70-75	70-75	90-95	115-120









SPOTLIGHT WITH LINEAR SOLUTION

 VOLTAGE(V) 220-240
 CCT(K) 3000/4500/6500
 PF ≥ 0.9
 IP 20
 CRI ≥ 80
 BEAM ANGLE 40°
 LIFETIME(H) ≥ 15000

WATTAGE(W)	5	8
LUMINOUS(LM)	400	640
DIMENSION(MM)	$\Phi 95 \times 95 \times 24$	$\Phi 95 \times 95 \times 24$
HOLZ SIZE	78-85	78-85



LED MIRROR LIGHT

 VOLTAGE(V) 220-240
 CCT(K) 2700-7000
 OPERATING TEMP -20-40°C
 CRI ≥ 80
 LIFETIME(H) ≥ 25000
 PF ≥ 0.5
 DIMENSION(MM) 600

MODEL	25-01	25-02	25-03	25-04
WATTAGE (W)	25 ± 10%	25 ± 10%	25 ± 10%	25 ± 10%
EFFICIENCY(LM/W)	> 80	> 80	> 80	> 80

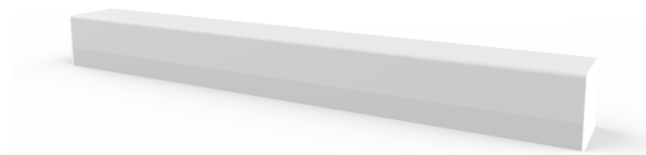

CCT :

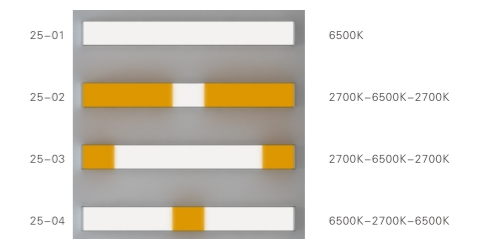

LED DOWNLIGHT

 VOLTAGE(V) 220-240
 CCT(K) 3000-6500
 PF > 0.5
 CRI ≥ 80
 MATERIAL AL+PLASTIC
 LIFETIME(H) ≥ 15000

WATTAGE(W)	8	10	12
LUMINOUS(LM)	500/560	600/620	670/700
DIMENSION(MM)	$\Phi 110 \times 40 \pm 2$	$\Phi 110 \times 40 \pm 2$	$\Phi 110 \times 40 \pm 2$



LED OUTDOOR LUMINAIRES SERIES

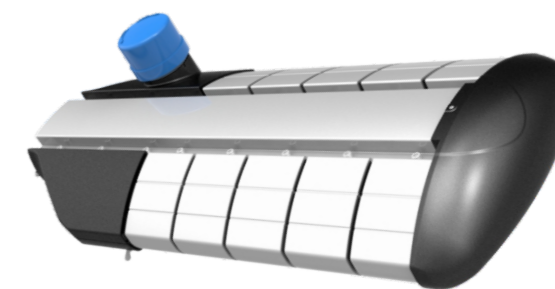

STREET LIGHT -STAR SERIES-B

- VOLTAGE(V)
100-277
- CCT(K)
3000-6500
- MATERIAL
AL
- DIAMETER
Φ60 ± 5mm
- PF
≥0.95
- CRI
≥70
- IP
66
- LIFETIME(H)
≥50000

WATTAGE(W)	30/50	80/100	120/150	180/200	250
LUMINOUS(LM)	4200/7000	11200/14000	16800/21000	25200/28000	35000
DIMENSION(MM)	386x300x92	466x300x92	546x300x92	626x300x92	706x300x92



STREET LIGHT -STAR SERIES-B II

- VOLTAGE(V)
100-277
- CCT(K)
3000-6500
- MATERIAL
AL+PLASTIC
- DIAMETER
Φ40 ± 5mm
- PF
≥0.95
- CRI
≥70
- IP
66
- LIFETIME(H)
≥50000

WATTAGE(W)	30	60
LUMINOUS(LM)	≥4200	≥8400
DIMENSION(MM)	407x215x75	496x215x75

INSTALLATION

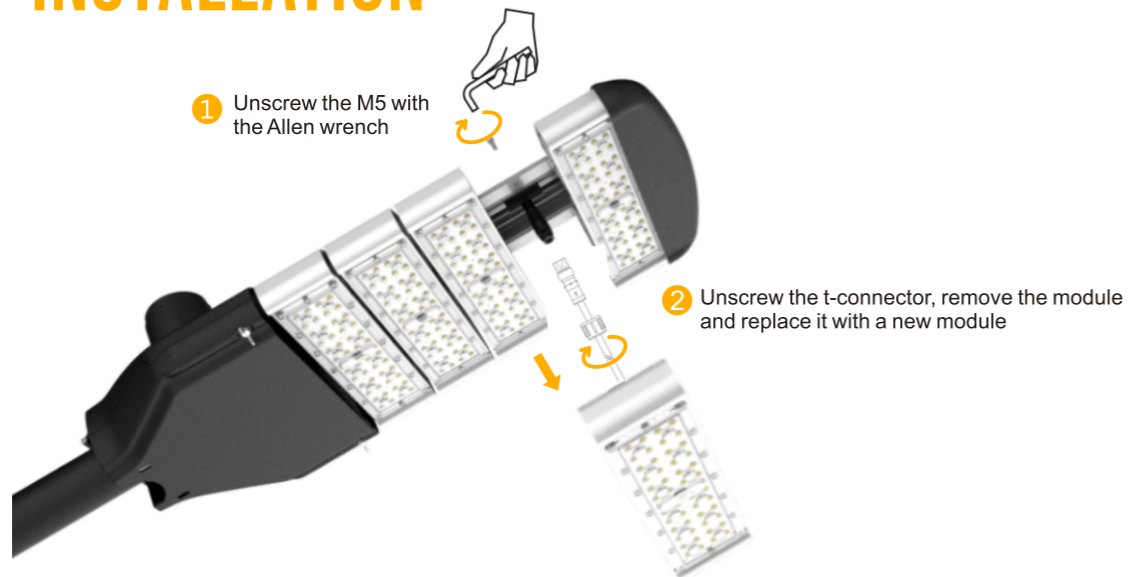

This series of products do not need to remove the lamp in maintenance, just unscrew 2 M5 screws to replace the broken module, the process is simple and fast



SOLAR LED STREET LIGHT SOLUTION-G

SMART LED STREET LIGHT SYSTEM

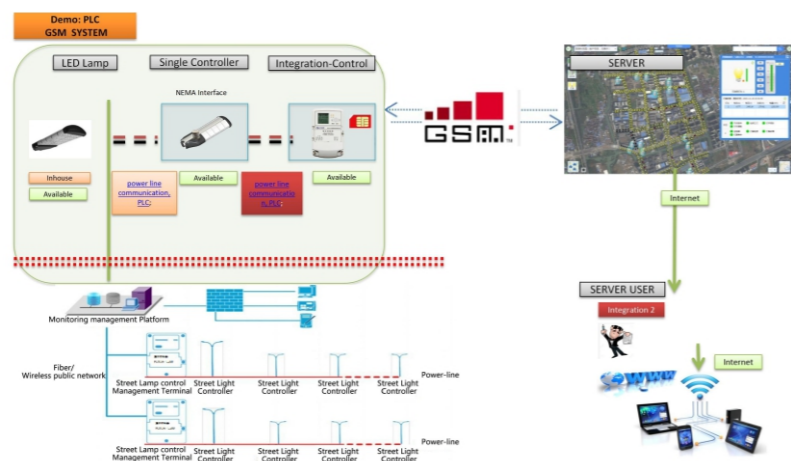

WATTAGE(W)	CCT(K)	CRI	LUMINOUS(LM)	BEAM ANGLE	IP	LIFETIME(H)
10	3000-6500	≥ 70	800	140° x70°	65	25000-50000
20			1600			
30			2400			
40			3200			
50			3600			
60			4800			



Description		Type:YGSLED30G	Type:YGSLED60G
Photovoltaic Panel	Voltage	18V/60W~Monocrystalline silicon	18V/80W~Monocrystalline silicon
	Life	20 Years	
Lithium Battery	Battery Capacity (AH)	12V 32AH 3.5KG	12V 42AH 4.0KG
	Life	3-5 Years	
The consecutive lamp working days when the battery fully charged under the condition of rainy days		3 to 5 consecutive rainy days	
LED Parameters	Power	12V 30W	12V 60W
	Luminous flux	3600-3900lm	7200-7800lm
	Life	50000H	
Installation height		7-8M	
Housing		Die Casting Aluminum	
Size and Weight	Lamp Size	384x188x55mm	432x220x70.5mm
	Lamp Weight	1.3kg	1.7kg
	Pv Panel Size	670x530x35mm	760x670x35mm
	Pv Panel Weight	3.7kg	5.5kg

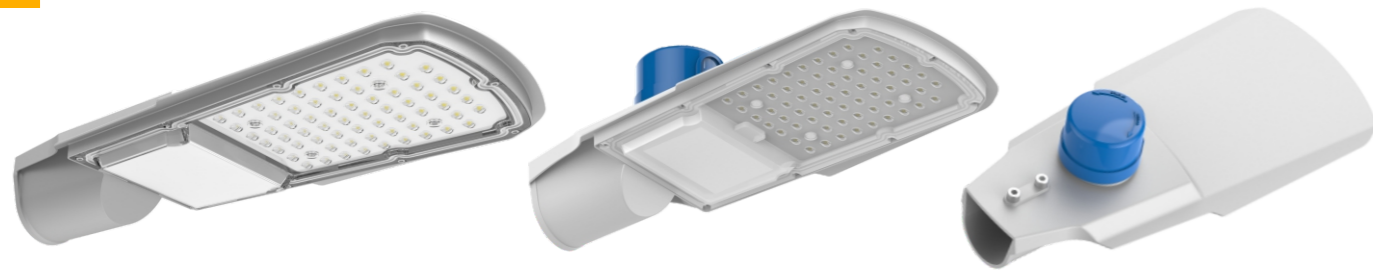

PLANET G SLIM STREET LIGHT

- VOLTAGE(V)
100-277
- CCT(K)
3000-6500
- MATERIAL
AL+PLASTIC
- PF
≥0.95
- CRI
≥70
- IP
66
- LIFETIME(H)
50000

WATTAGE(W)	30	60	80	100
LUMINOUS(LM)	≥3600	≥7200	≥9600	≥12000
DIMENSION(MM)	367x171x50	433x171x50	532x283x90	532x283x90
DIAMETER	Φ40 ± 5mm	Φ60 ± 5mm	Φ60 ± 5mm	Φ60 ± 5mm

INTEGRATED SOLAR STREET LAMP

- VOLTAGE(V)
12
- CCT(K)
3000-6500
- BEAM ANGLE
140°x70°
- CRI
≥70
- IP
65

WATTAGE(W)	30	50	80	100	150
LUMINOUS(LM)	2400	3600	4800	6000	8400
DIMENSION(MM)	1246x365x135	1416x365x135	1218x537x150	1398x537x150	1938x537x335







FLOOD LIGHT-C



Model	YGFLSDI30W-3W	YGFLSDI40W-5W	YGFLSDI70W-9W	YGFLSDI96W-12W
Rated power	3W /3.2V	5W/3.2V	9W/3.2V	2W/3.2V
Lamp bead power	30W (60*0.5/LED)	40W (80*0.5/LED)	70W (140*0.5/LED)	96W (192*0.5/LED)
Luminous flux	360lm	600lm	1080lm	1440lm
Color temperature	3000K 4000K 5000K 5700K 6500K			
Luminous angle	90°			
Color rendering index	80			
Lamp size	L195*W155*H50mm	L235*W195*H55mm	L265*W225*H65mm	L315*W265*H70mm
Battery Specification	3.2V 5.5AH	3.2V 11AH	3.2V 16.5AH	3.2V 22AH
Battery charging time	5-7H			
Working temperature	Charge: 0~60°C Discharge: -10~60°C			
Storage temperature	-20~25 °C (< 1years) ,-20~40 °C (< 3 months)			
Photovoltaic panel power	10W/6V	12W/6V	18W/6V	25W/6V
Charging current	1.67A	2A	3A	4.16A
PV panel size	L350*W235*H17mm	L350*W290*H17mm	L350*W430*H17mm	L350*W530*H17mm
Lighting duration of lamps	Automatic sensitization ≤16h	100% ≤5h	50% ≤11h	15% ≤37h
Remote control mode	Infra-red			
Life	25000H			
Waterproof grade	IP65			

TUNNEL LIGHT -GEMINI SERIES-A

-  VOLTAGE(V)
100-277
-  CCT(K)
3000-6500
-  MATERIAL
AL+PLASTIC
-  PF
≥0.95
-  CRI
≥70
-  IP
66
-  LIFETIME(H)
≥50000



WATTAGE(W)	50	100	150	200	250
LUMINOUS(LM)	6000	12000	18000	24000	30000
DIMENSION(MM)	220x301x254	274x301x254	354x301x254	434x301x254	514x301x254







FLOOD LIGHT-A

-  VOLTAGE(V)
220-240
-  CCT(K)
2700-7000
-  MATERIAL
AL+GLASS
-  PF
≥0.9
-  CRI
≥70
-  IP
66
-  LIFETIME(H)
≥25000



WATTAGE(W)	30	50	70
LUMINOUS(LM)	2700	4500	6300
DIMENSION(MM)	146x142x31	218x153x31	245x192x31





TUNNEL LIGHT -GEMINI SERIES-B

-  VOLTAGE(V)
100-277
-  CCT(K)
3000-6500
-  MATERIAL
AL
-  PF
≥0.95
-  CRI
≥70
-  IP
66
-  LIFETIME(H)
≥50000



WATTAGE(W)	50	100	150	200	250
LUMINOUS(LM)	5500	11000	16500	22000	30000
DIMENSION(MM)	105x337x231	153x337x231	232x337x231	311x337x231	391x337x231

FLOOD LIGHT-B

-  VOLTAGE(V)
220-240
-  CCT(K)
3000-6500
-  MATERIAL
AL+GLASS
-  PF
≥0.9
-  CRI
≥80
-  IP
66
-  LIFETIME(H)
≥25000



WATTAGE(W)	10	20	30	50	100	150/200	300
LUMINOUS(LM)	800	1600	2700	4500	9000	13500/18000	27000
DIMENSION(MM)	103x83x24	160x122x26	160x122x26	206x160x33.5	270x210x33.5	350x280x40	445x335x45

FLOOD LIGHT-C

VOLTAGE(V) 220-240 CCT(K) 3000-6500 PF ≥ 0.95

MATERIAL AL+GLASS CRI ≥ 80 IP 66 LIFETIME(H) ≥ 25000



WATTAGE(W)	10	20	30	50	70	100
LUMINOUS(LM)	800	1600	2700	4500	6300	9000
DIMENSION(MM)	102x71x16	146x142x31	218x153x31	245x192x31	245x172x32	305x205x37

FLOOD LIGHT-E

VOLTAGE(V) 220-240 CCT(K) 3000-6500 MATERIAL AL+GLASS

PF ≥ 0.9 CRI ≥ 80 IP 65 LIFETIME(H) ≥ 25000



WATTAGE(W)	10	20	30	50	70	100	150	200
LUMINOUS(LM)	900	1800	1800	4500	6300	9000	13500	18000
DIMENSION(MM)	85x90x25	95x75x25	125x119x27	170x145x28	210x173x34	250x221x35	280x262x36	300x311x36

FLOOD LIGHT-G

VOLTAGE(V) 110-265 CCT(K) 3000-6500 PF ≥ 0.5

MATERIAL AL+GLASS CRI ≥ 80 IP 65 LIFETIME(H) ≥ 25000



WATTAGE(W)	10	20	30	50	70	100	200	300	400
LUMINOUS(LM)	800	1600	2400	4000	5600	8000	16000	27000	36000
DIMENSION(MM)	118x126x40	180x184x36	227x221x50	274x285x50	290x377x70	290x377x70	325x425x75	443x400x80	468x465x90

HIGHBAY UFO SERIES-A

VOLTAGE(V) 100-277 CCT(K) 3000-6500 PF ≥ 0.95

MATERIAL AL+PLASTIC CRI ≥ 70 IP 65 LIFETIME(H) ≥ 50000



WATTAGE(W)	60	100	150	200	300
LUMINOUS(LM)	7200	12000	18000	24000	36000
DIMENSION(MM)	$\Phi 235 \times 120$	$\Phi 280 \times 185$	$\Phi 340 \times 187$	$\Phi 400 \times 196$	$\Phi 460 \times 260$

HIGHBAY NEPTUNE SERIES-D

- ⚡ VOLTAGE(V)
100-265
- ∞ CCT(K)
3000-6500
- 🔧 MATERIAL
AL+PLASTIC
- Ⓜ PF
≥0.9
- 🔗 CRI
≥70
- 🛡️ IP
20
- 🕒 LIFETIME(H)
≥25000

WATTAGE(W)	50	100	150
LUMINOUS(LM)	5500	11000	16500
DIMENSION(MM)	Φ284x216	Φ397x283	Φ450x351



FLOOD LIGHT-G

- ⚡ VOLTAGE(V)
220-240
- ∞ CCT(K)
3000-6500
- 🔧 MATERIAL
AL+GLASS
- Ⓜ PF
≥0.9
- 🔗 CRI
≥80
- 🛡️ IP
66
- 🕒 LIFETIME(H)
≥25000

WATTAGE(W)	100	150	200
LUMINOUS(LM)	10000	15000	20000
DIMENSION(MM)	Φ235x167	Φ283x167	Φ353x167



WALL WASH LIGHT

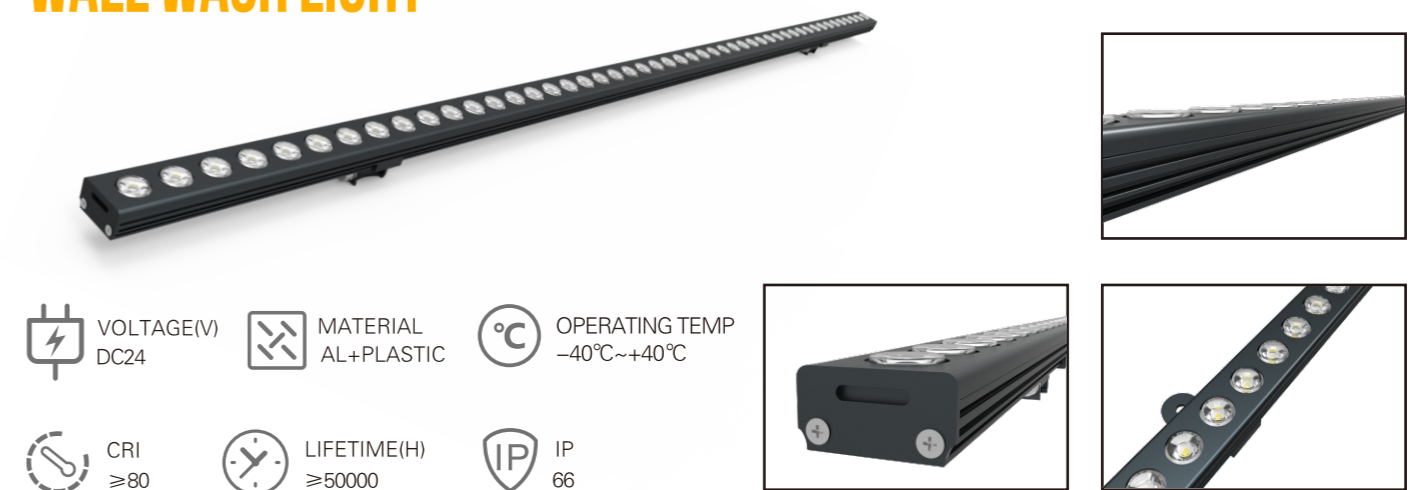

- ⚡ VOLTAGE(V)
DC24
- 🔧 MATERIAL
AL+PLASTIC
- 🌡️ OPERATING TEMP
-40°C~+40°C
- 🔗 CRI
≥80
- 🕒 LIFETIME(H)
≥50000
- 🛡️ IP
66

WATTAGE (W)	BEAM ANGLE	CCT (K)	DIMENSION (MM)
12	15° /25° /45° /10x85°	2200-4000	1000x30x23
18	15° /25° /45° /10x85°	2200-4000	1000x30x23
24	15° /25° /45° /10x85°	2200-4000	1000x30x23

EDUCATIONAL LIGHTING SERIES

EDUCATIONAL LED LIGHT

PRODUCT FEATURES



Full spectrum:
CRI > 95, R9 > 95, Rg > 96.

Comfortable for eyes:
UGR < 16; Light stroboflash: no harm;
Blue light hazard rating: RG0;
CCT: 4500-5200K.

Intelligent control:
Different patterns of illumination requirements can be set.

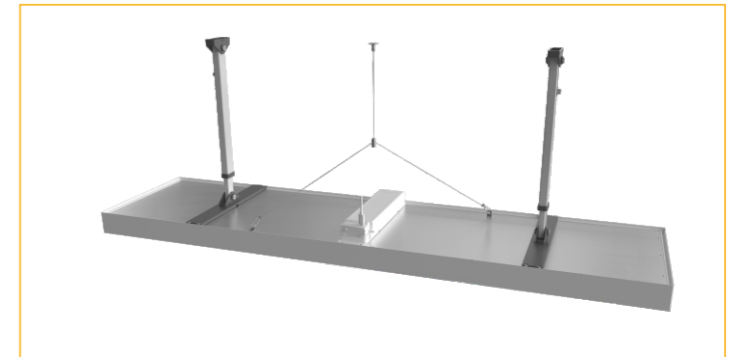
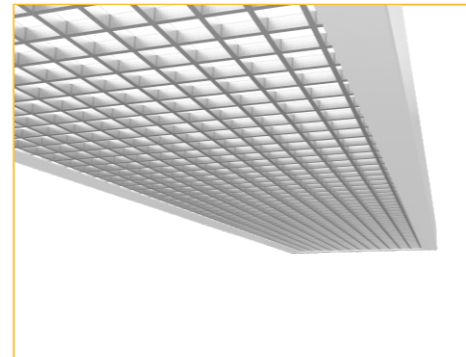

COMPARED TO STANDARD

Item	GB7793-2010(china)	Before T8 classroom		After woojong led eductions light classroom	
Desk surface illumination	≥300lx	158lx	Low	503lx	High
Uniformity of illumination	≥0.7	0.58	Low	0.8	High
The blackboard illumination	≥500lx	220lx	Low	641lx	High
Glare	< 19	23	Bad	10	Good
Stroboflash	--	20%-50%	Bad	Invisible	Good
CRI	≥80	70-80	Bad	98	Good
CCT	3300K-5500K	6500K	Too white	4950K	Access to natural light

PARAMETER



PARAMETER	CLASSROOM LIGHT	BLACKBOARD LIGHT
VOLTAGE	220(100-240V)Vac	220(100-240V)Vac
Operating Frequency	50/60Hz	50/60Hz
Input Power	48W	20W
Efficacy	90lm/W	90lm/W
CCT	4500-5200K	4500-5200K
CRI(Ra)	≥95	≥95
Power Factor	≥0.9	≥0.9
Operating Temp	-20/+40°C	-20/+40°C
Dimensions	1200x300x70mm	1225 ± 3x89 ± 3x85 ± 3mm
Flick	Non-hazardous	Non-hazardous
Blu-ray hazard	Rg0	Rg0
Spectral characteristic	Full Spectrun(Rf > 95, Rg: 98)	Full Spectrun(Rf > 95, Rg: 98)
UGR	≤ 16	≤ 16
Life	≥ 50000h	≥ 50000h

CASES

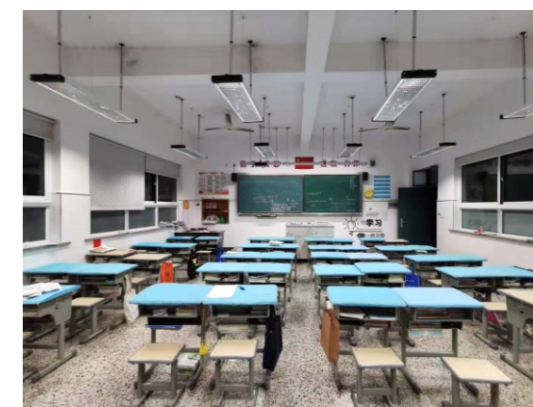

DESK LAMP



COMPARED TO STANDARD

Power	12W
Voltage(V)	220-240
PF	0.5
CCT(K)	3500/3750/4000
CRI	≥95
Initial Luminous	800LM ± 10%
Colour	White
Semitransparent Cover Material	PS
Material of Heat sink	AL6063+ABS
Certification	CCC/CE
Operating Temperature	-10°C~40°C
Rated Life-span	25000H
Warranty	3Years
Dimension	258mmx315.5mmx378.5mm(± 3mm)
Product Weight	1.42kg ± 20g

PRODUCT FEATURES

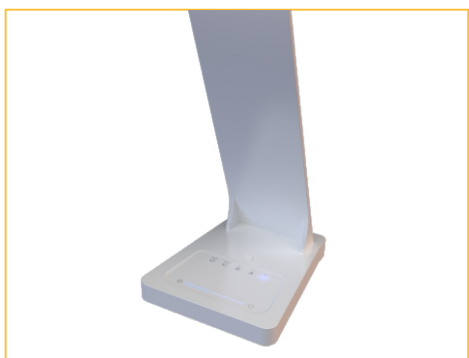

1. Using constant isolated power supply, safety, stability.
2. Self invented and patented visible light secondary excitation luminescence technology: achieve high index CRI > 95, high color saturation RG > 90, R9 > 95, high color fidelity RF > 90 effect, provide comfortable, eye protection, healthy and distortion free light environment.
3. No harm of blue light, no glare, no visual fatigue, no trouble of myopia.
4. No stroboscopic, protect retina.
5. The angle of the light panel can be adjusted to meet the needs of different scenes.
6. Solid integrated lamp body, advanced surface treatment technology, simple and fashionable appearance.
7. Platonic shape design, full of artistic flavor, is a real masterpiece of ingenuity.

- Unlimited dimming
- Tricolor dimming
- Night light
- Regular rest
- Light-sensing self-movement light function

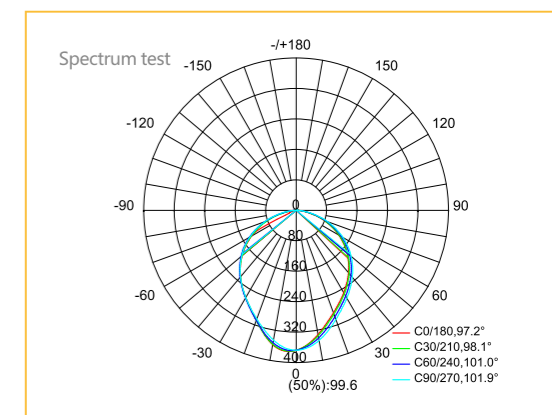

LED UV LIGHT SERIES



INTELLIGENT INTEGRATED LIGHTING UV STERILIZING LUMINAIRE

SPECIFICATION	LED LIGHTING LAMP		UV STERILIZATION LAMP	
Power	24W		48W	
Voltage	220V			
Frequency	50/60Hz			
PF	≥0.5			
Function	Human body infrared induction+Timing control			
UV illumination			2.8W/M ² (@1M)	
Sterilized lamp tube material	/		Quartz UV lamp tube	
Size	380x380x42mm			
Life	25000h		8000h	
Standard	IEC60335/GB7000-2015、GB19258-2012			
Areas of application	Kitchen, balcony, toilet, dining room, bedroom, living room	Kitchen, balcony, toilet (area about 10m ²)	Dining room and bedroom (area about 20m ²)	Living room, large bedroom (area about 40m ²)
Recommended sterilization time (uv lamp working mode)	/	15 minutes	30 minutes	60 minutes

Surface installation

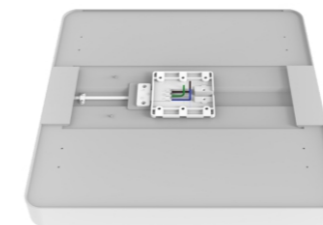

Build-in installation

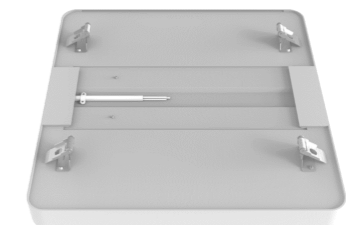

PORTABLE UV STERILIZING LUMINAIRE

SPECIFICATION	UV LAMP		
Power	40W		
Voltage	220V		
Frequency	50/60Hz		
PF	≥0.5		
Function	3 level timing control		
Sterilized lamp tube material	Quartz UV lamp tube		
Bracket material	Metal lamp bracket+high temperature paint treatment		
Size	Φ190x453mm		
Life	8000h		
Standard	IEC60335/GB19258-2012		
Areas of application	Kitchen, balcony, toilet (area about 10m ²)	Dining room and bedroom (area about 20m ²)	Living room, large bedroom (area about 40m ²)
Recommended sterilization time	15 minutes	30 minutes	60 minutes

